

Volume 22  
Issue 1  
September  
2014

# The Pygmy Owl

The Newsletter of the  
Spokane Audubon Society

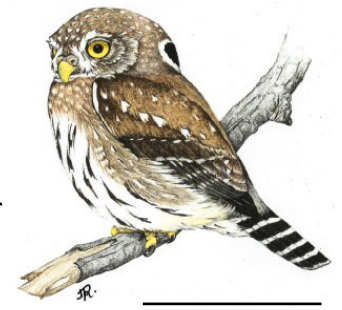

## SAS Programs Resume September 10<sup>th</sup>: *Washington's Not-So-Common Loon,* Presented by Ginger Gumm

Welcome back! Please join us on September 10<sup>th</sup> for our first presentation of the year, when Ginger Gumm will give a presentation about Loon geo-location.

*Spokane Audubon's September program will be held at the Riverview Retirement Community, Village Community Building (Directions on page 8.)*

*Please join us at 7 p.m. for refreshments and friendly conversation. The program will begin at about 7:30 p.m., after announcements.*

## The 2015 Calendar is Here!



*Northern Harrier by Marlene Cashen*

See page 3 for more details about where to buy and prices.

### Mark your Calendars!

September 6  
**Sprague Lake Migrant Field Trip**  
(see page 7 for details)

September 18  
**October Newsletter Deadline**  
send material to  
[carmen@floreo.com](mailto:carmen@floreo.com)

September 19 -21  
**Audubon Council of  
Washington (ACOW)  
Weekend**

September 19  
**GIS/Mapping Workshop**  
at ACOW

September 19  
**WSACC Meeting at ACOW**

September 20  
**ACOW Meeting**

September 21  
**ACOW Field Trip**  
(see page 6 for details  
about ACOW, including tickets  
and accommodations)

October 4  
**Turnbull Planting Party**  
(see page 6 for details)

October 25  
**Grant County Late Fall  
Migrant Field Trip**  
(see page 7 for details)

## The Pygmy Owl

Volume 22, Issue 1 ~ September 2014

*The Pygmy Owl*, the newsletter of the Spokane Audubon Society, is published monthly, September through June.

Spokane Audubon Society  
P.O. Box 9820  
Spokane, WA 99209-9820

Owl illustrations on pg. 1 and pg. 8 © Jan Reynolds.



### Officers

#### President

Fran Haywood      birders13@gmail.com

#### Vice President

Tim O'Brien      kertim7179@yahoo.com

#### Treasurer

Lindell Haggin      lindell4118@comcast.net

#### Secretary

Ed Reynolds      edndaisy@aol.com

### Elected Board of Directors

Joyce Alonso	jbalonso3@msn.com
Bob Cashen	mjaycashen@aol.com
Marlene Cashen	mjaycashen@aol.com
Brad Haywood	birders13@gmail.com
Gary Lee	bird_fan@aol.com
Jan Reynolds	edndaisy@aol.com

### Committee Chairs

#### Field Trips

Jon Isacoff      isacoff@gonzaga.edu

#### Programs

Gary Lee      bird\_fan@aol.com

#### Education

Joyce Alonso      jbalonso3@msn.com  
Lindell Haggin      lindell4118@comcast.net

#### Conservation

Greg Gordon      fightingbull63@gmail.com

#### Hospitality

Jan Strobeck      jandeerpark@aol.com

#### Membership

Dave Plemons      davep\_nublado@me.com

#### Publication

John English      jhe230@yahoo.com

#### Publicity

Kim Thorburn      kthorburn@msn.com

#### Pygmy Owl

Carmen Yount      carmen@floreo.com

#### Volunteer Coordinator

Joyce Alonso      jbalonso3@msn.com

#### Website

Alan McCoy      spokaneaudubon.org

## President's Message

by Fran Haywood

I am excited to start Spokane Audubon's new year in September. This will be my last year as your president and I have enjoyed every minute because of all the help I have had. We will be holding elections next May at our last meeting of the year and I hope someone will be willing to help lead this wonderful organization.

The board has been busy this summer with a very productive meeting hosted by Lindell at her lovely home on the Little Spokane River. Gail Gatton and Christi Norman came from the State office and updated us on what is happening with other chapters and also at the state level.

We are hoping to extend the sagebrush bird survey that started in the Tri-Cities and Yakima last year to our area. The goal of the survey is to discover the status of sagebrush birds in our area. We invite you to volunteer for this project as a study coordinator, or GPS specialist or GIS specialist. We also need birders with good ears to conduct the counts. We will be partnering lesser-skilled birders with more advanced birders. No need to worry if you feel unqualified; there will be training sessions for anyone interested locally and at the State meeting. The protocol for these counts is simple, with only one point count in each area. We walk into it, counting to the point, count the area and also count on the way back. It takes very little time at daylight and then you are free to bird on your own. Some of the areas will be new to local birders. All results will be posted on e-bird.

This summer, Lindell has been very busy working on adding to Audubon Lakes. Mary Jokela has agreed to attend a conference on forage fish protection. Several of us are planning to attend the State meeting at Ocean Shores. Joyce has been really busy with education, teaching classes for Friends of Turnbull, doing school classes, and a huge Boy Scout group. Of course there are the dedicated volunteers at Turnbull: Spring fest was a great success, and Marian & Russell, Tim, Kim, and Brad & I enjoyed point counts there and Marian & Russell also spent many hours banding. Lindell, Ann, and I helped with the last year of the bobolink study.

Many more of you put in time with research, attending meetings and conference calls, and writing letters representing us, and then there are the dedicated field trip leaders, and our wonderful webmaster, Alan. Thank you everyone.

There is much to do in the coming year and I hope many of you will join us. We all have found that we have fun and enjoy wonderful like-minded people.

Available  
Now!

## 2015 Spokane Audubon Society Calendar



*Northern Pygmy Owl, by Tom Munson*

Spokane Audubon's photographers and calendar committee have done it again! The 2015 calendar is available now, and it is as beautiful as ever.

Celebrate the incredible talent and craftsmanship of our photographers and support Spokane Audubon by purchasing a calendar. Calendars will be available at meetings, via [spokaneaudubon.org](http://spokaneaudubon.org), or at Auntie's bookstore in downtown Spokane.

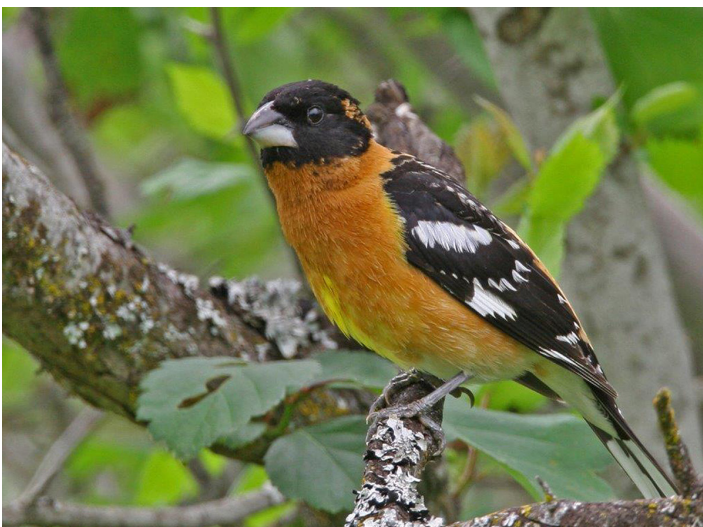

*Black-headed Grosbeak, by Buck Domitrovich*



*Wilson's Snipe, by Bob Cashen*

### *Birds of Eastern Washington*

featuring photos by  
Spokane Audubon members.

If you purchase them  
at a meeting, they're

**\$10 each**

Calendars are available at meetings, by mail  
or through [spokaneaudubon.org](http://spokaneaudubon.org) (using PayPal).

Note: Shipping charges apply for all mail/online orders:

- 1 calendar: \$10 + \$3 s&H = \$13
- 2 calendars: \$20 + \$4 s&H = \$24
- 3 - 6 calendars: \$30 + \$7 s&H = \$37

Contact Spokane Audubon for  
shipping costs for 7+ calendars.

To order by mail, send check to:

Spokane Audubon Society  
15418 Little Spokane Drive  
Spokane, WA 99208

Make checks payable to *Spokane Audubon*.

# Citizen Science in Your Own Backyard

## Cornell Lab of Ornithology's

# YardMap

<http://content.yardmap.org/>



### What is it?

The YardMap Network is a citizen science project designed to cultivate a richer understanding of bird habitat, for both professional scientists and people concerned with their local environments. The YardMap project collects data by asking individuals across the country to literally draw maps of their backyards, parks, farms, favorite birding locations, schools, and gardens. It connects you with your landscape details and provide tools for you to make better decisions about how to manage landscapes sustainably.

YardMap is also the world's first interactive citizen scientist social network. When you join you are instantly connected to the work of like-minded individuals in your neighborhood, and across the country. Together you can become a conservation community focused on sharing strategies, maps, and successes to build more bird habitat.

(For those of you looking for a way to engage tech wizard kids and grandkids with the natural world—and science—this seems like a great activity to investigate!)

### The Science of YardMap:

What kinds of questions are we seeking to answer with your help?

- What practices improve the wildlife value of residential landscapes?
- Which of these practices have the greatest impact?
- Over how large an area do we have to implement these practices to really make a difference?
- What impact do urban and suburban wildlife corridors and stopover habitats have on birds?

- Which measures (bird counts? nesting success?) show the greatest impacts of our practices?

### How does it work?

1. Go to the YardMap website: <http://content.yardmap.org/>
2. Create an account. (If you have an eBird account, you can sign in using that information!)
3. Start mapping your yard using the toolset provided by the Cornell Lab. (There are demonstration videos and tutorials—you won't get lost.)
4. Follow the guidelines for creating a "full and complete" yard map: <http://content.yardmap.org/help/guidelines-for-a-full-and-complete-yardmap/>
5. Explore the site. There are many ways to use the mapping tools and to contribute to the project. You can also see local sightings reported on eBird, get to know our ecoregion ("Northern Rocky Mountain Forest-Steppe-Coniferous Forest-Alpine Meadow Province"), and find out about native plants and the animals that depend on them.

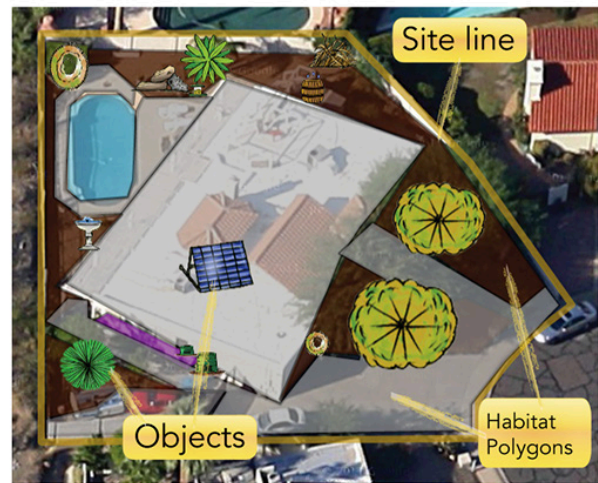

*An example of a full and complete Yard Map. Image from Cornell Lab of Ornithology, YardMap Network.*

There are a number of helpful resources and recommendations offered on the web site, including definitions of habitat, plant communities and landscape features, and hints for cultivating habitat under different conditions (a new house, park, office, abandoned lot or median). The YardMap site also has some book recommendations for making yards more friendly to birds (and other wildlife).

YardMap offers citizen scientists an opportunity to study and share what goes on in our own backyards. Check it out!

---

## *Notes from the Little Pend Oreille National Wildlife Refuge Camping Trip:*

*June 20 - 22, 2014*

by Fran Haywood

Perfect weather, wonderful company and great birds defined this year's campout. We had a great turnout this year: Brad and I were joined by co-leader Joyce Alonso and five other couples, including the Lights, the Burts, the Lees and the Harrisons.

We camped at the McDowell Lake horse camp where we had plenty of room. The boardwalk trail was wonderful for birding and photography. In a dramatic moment, Cathy Lee was almost run over by a moose while she was snapping wildflower pictures!

The headquarters area proved the most productive for numbers of species and easy viewing, but each spot added to our list. We were disappointed not to find our target woodpeckers, but otherwise were pleased with the bounty of birds.

The highlights from headquarters included Eastern Kingbirds, all three species of hummingbird, three swallow species (Tree, Cliff and Violet-Green), American Kestrel, Turkey Vulture, Western Bluebird, Red-Tailed Hawk, Lazuli Bunting, Red-eyed and Cassin's Vireos, Gray Catbird, Red-breasted Nuthatch, Black-capped Chickadee, Willow Flycatcher, Song Sparrow, Yellow Warbler and Chipping Sparrow.

At Cottonwood Creek, we added Veery, Red-naped Sapsucker, Black-headed Grosbeak, MacGillivray's Warbler, American Redstart, Swainson's Thrush, Ruby-crowned Kinglet, Warbling Vireo and a Rufus Hummingbird on a nest, spotted by one of our sharp-eyed birders.

For our fill of waterfowl, we headed to Bayley Lake, where we saw Canada Geese, Coot, Ring-necked, Common Goldeneye, and Wood Ducks, along with Red-winged Blackbirds.



*Moose crossing. Photo by Cathy Lee.*



*Flower with guest... before or after the Moose?  
Photo by Cathy Lee.*



*Gary Lee and Fran Haywood. Photo by Cathy Lee.*

At McDowell Lake overlook, we watched a pair of Common Loon, Spotted Sandpipers, and an Osprey.

We discovered that our campground was the perfect spot for studying Empids, as several were feeding there while singing and calling. Western, Dusky, and Hammonds Flycatchers were all very active and it was easy to compare them and connect their songs.

---

## 2014 ACOW\*

### \* Audubon Council of Washington September 19 - 21, 2014 Shilo Inns Ocean Shores, WA

The Audubon Council of Washington (ACOW) is an annual statewide meeting where members from all Audubon Chapters in Washington gather together for a day information sharing, knowledge gathering, and fellowship. The meeting will take place on Saturday, September 20.

#### September 19: GIS Workshop for Chapter Leaders, led by Connor Bailey noon - 4 p.m.

Connor Bailey is the new Pacific and Central Flyway Enterprise GIS Support Specialist for NAS Conservation Planning. Based out of Colorado, Connor is tasked with assisting chapters and states with their GIS and mapping needs. He is excited to meet the talented chapter leaders working in Washington State and will be leading a half day GIS/Online Mapping workshop at the Shilo Inn the Friday before ACOW begins.

#### September 19: WSACC Meeting 6 p.m. - 8 p.m.

Join other WSACC participants to make important decisions regarding state-wide conservation priorities and discussing issues and actions we can collectively support and engage with our membership.

#### September 21: Field Trip!

**Meet at 8 a.m. at the South End of Ocean Shores Blvd.** Cap off ACOW 2014 with some local birding! Dianna Moore of Grays Harbor Audubon Society will be leading a field trip on Sunday, September 21, to Bottle Beach SP, checking out the North Jetty in Ocean Shores and possibly the sewage lagoon.

Accommodations are available at the Shilo Inns for \$99/night (rooms are being held for "Audubon," but it's best to call them directly for those: 360-289-4600.), or at the Quality Inn (next door to the Shilo) for \$89/night, or you can camp at the Ocean City Campground.

More info online:

<http://wa.audubon.org/chapter-meetings>

To buy Tickets:

<http://acow2014.brownpapertickets.com/>

### Community Planting Party Turnbull NWR Saturday, October 4 9 a.m. to Noon

Come celebrate National Wildlife Refuge Week by planting a tree to help offset our carbon footprint. Turnbull National Wildlife Refuge and Spokane Audubon Society will host a community work party on Saturday, October 04, 2014.

This ongoing community effort restores native riparian habitat to benefit birds and other wildlife species. We have hundreds of native saplings to plant. We will also erect fencing at the project site to protect the trees from deer, elk, and moose browsing. Everyone is welcome to participate!

**Where:** Turnbull NWR Headquarters, 5 miles south of Cheney on Cheney-Plaza Road: turn left on Smith Road and drive 2 miles on gravel road to headquarters.

**Clothing:** Long-sleeved shirt, work pants, sturdy boots or shoes, gloves.

**Equipment:** (If you can) shovels and pliers.

There will be a potluck at noon, immediately following the planting activities. (Friends of Turnbull will supply the hamburgers.)

---

### *Birds, Birders and Birding in the News*

"The growing human population leads to increased pressure on natural systems. Increased shoreline development can destroy natural habitat, which impacts forage-fish spawning habitat. The shrinking of the forage-fish population weakens a critical link in the marine food web because these fish are an energy-rich food source for larger fish, marine mammals and birds." ~ Trina Bayard, Director of Bird Conservation, Audubon Washington, in a guest column published in *The Seattle Times*, August 15, 2014.

"I tell them that the birds are a gift to help them get through each day, a way to enjoy the world while we change it so that young people, everywhere, have a chance. I tell them that when the world is caving in on them, just walk outside, listen for a minute, find that cardinal, that woodpecker, that pesky crow, and see what they're up to. That tiny act, that five-minute pause, won't save the planet, I tell them, but it might save you, one bird at a time." ~ Trish O'Kane, "What the Sparrows Told Me," *The New York Times*, August 16, 2014.

---

## SAS Field Trips: September and October

### September 6, 2014 Saturday Sprague Lake Migrant Trip Leader: Norma Trefry

This is a half-day trip to the Sprague Lake area to look for migrating birds, and birds that often stray here in September. Meet at Coeur d'Alene Park at 7 am.

Please contact Norma ([firsttrefry@gmail.com](mailto:firsttrefry@gmail.com), 926-2533) by August 30 to confirm participation.

Target Birds: Waterfowl, loons and grebes, White Pelican, Peregrine Falcon, Red-necked Phalarope, Sabine's Gull (rare), terns, American Pipit, migrant sparrows and warblers.

### October 25, 2014, Saturday Grant County Late Fall Migrant Trip Leader: Gary Blevins

This is a beginning, intermediate and advanced birder-oriented trip to look for specialty birds, such as Arctic Gulls, Lapland Longspurs, and other hard to find and see northern visitors. There may be some down time, with little action in between bird sightings, but potential for rarities is high. It is a full-day trip from sunrise to sunset. Contact Gary Blevins (533-3661 or [garyb@spokanefalls.edu](mailto:garyb@spokanefalls.edu)) by October 18 if you plan to attend.

Target Birds: Loons and grebes; scoters and rare wintering waterfowl; wintering raptors; Glaucous, Thayer's, and Glaucous-winged Gulls; Snowy Owl; Northern Shrike; Snow Bunting; Lapland Longspur; Gray-crowned Rosy Finch

---

## Spokane Audubon Society Membership Form

Local Membership Dues:

Individual: \$20/year \_\_\_\_\_

Couple & Family: \$25/year \_\_\_\_\_

Student: \$10/year \_\_\_\_\_

Lifetime: \$300 \_\_\_\_\_

National Membership Dues: \$35/year \_\_\_\_\_

Individual + National Dues: \$55/year \_\_\_\_\_

Couple + National Dues: \$60/year \_\_\_\_\_

**Your local membership provides you with *The Pygmy Owl* and supports your local chapter's many conservation and education activities. You will also be eligible for website privileges.**

Name: \_\_\_\_\_

Address: \_\_\_\_\_

City: \_\_\_\_\_ State: \_\_\_\_\_

Zip Code: \_\_\_\_\_ Phone: \_\_\_\_\_

E-mail: \_\_\_\_\_



Please make check payable to:  
**Spokane Audubon Society**  
Send this form and your check to:

Audubon Membership  
Attn: Dave Plemons  
1224 W. Riverside #1101  
Spokane, WA 99201

Current members may renew memberships from our web site::

<http://spokaneaudubon.org>

Receiving duplicate newsletters?  
Errors or other changes needed on your mailing label? Contact Dave Plemons at [davep\\_nublado@me.com](mailto:davep_nublado@me.com), or 413-1524.



The Pygmy Owl  
**Spokane Audubon Society**  
 P.O. Box 9820  
 Spokane, WA 99209-9820  
 (509) 838-5828

Non-Profit  
 Organization  
 Spokane, WA  
 US Postage  
 PAID  
 Permit No. 34

Welcome Back!  
 Washington's Not-So-Common Loon,  
 with Ginger Gumm  
 September 10<sup>th</sup>, 7:30 p.m.

To:

*The Spokane Audubon Society provides resources and services to educate people about birds, wildlife, and the importance of habitats, and to advocate and support public policies and actions that conserve and restore wildlife habitats.*

**Visit our website: <http://spokaneaudubon.org>**

**Directions to the General Meeting:**

*Riverview Retirement Community, Village Community Building  
 2117 E. North Crescent Avenue*

**To get to Riverview Retirement Community:**

**From West Spokane & South Hill**

- I-90 East to Exit 281 toward US-2 E/US-395 N/ Newport/Colville
- Follow US-2 E/US-395 N to E. Mission Ave.
- Turn Right at E. Mission Ave.
- Turn Left at E. Upriver Drive

**From Spokane Valley**

- I-90 West to Exit 282A
- Follow N. Hamilton St. to E. Mission Ave.
- Turn Right at E. Mission Ave.
- Turn Left at E. Upriver Drive

**From North Spokane**

- Take US-395 S to E. Mission Ave.
- Turn Left at E. Mission Ave.
- Turn Left at E. Upriver Drive

**Once you're on E. Upriver Drive (see map below):**

- Follow E. Upriver Drive to N. Crestline Street
- Turn Left at N. Crestline Street
- Turn Right on E. North Crescent Drive
- Proceed to entry on left showing numbers 2105-2145

Limited parking is available by the Village Community Building. Overflow parking is along E. North Crescent Ave.

